

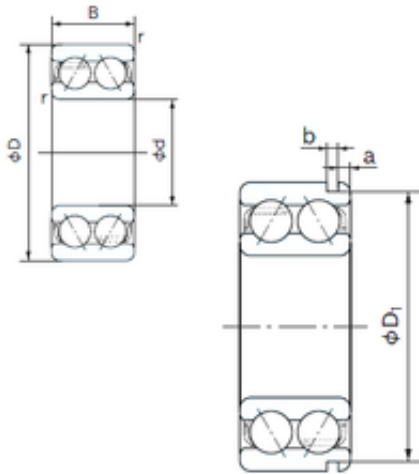

Shandong Zhongyue Precision Bearing C...



70 mm x 125 mm x 39.7 mm NACHI 5214AN
angular contact ball bearings

Bearing No. 5214AN

5214AN Bearing 2D drawings and 3D CAD models

Size	70x125x39.7 mm
Bore Diameter	70 mm
Outer Diameter	125 mm
Width	39.7 mm
d	70 mm
D	125 mm
B	39.7 mm
C	39.7 mm
a	4.06 mm
b	3.1 mm
r min.	1.5 mm
D1	120.22 mm
Weight	1.82 Kg
Basic dynamic load rating (C)	90,5 kN
Basic static load rating (C0)	79,5 kN
(Grease) Lubrication Speed	3200 r/min
Bore Type	Cylindrical Bore
Enclosure	Open
Configuration	Double Row
Bore Size	70 mm
Outside Diameter	125 mm
Width	39.7 mm
Fillet Radius/Chamfer	1.5 mm
Groove Width	3.1 mm
Groove Diameter	120.2 mm



Shandong Zhongyue Precision Bearing C...

a (max)	4.1 mm
Dynamic Load Rating	90,500 N
Static Load Rating	79,500 N
Limiting Speed - Grease	3,200 rpm
Limiting Speed - Oil	4,500 rpm
Radial Clearance	0.010 to 0.030 mm
da	79 mm
Da	116 mm
Dx	136.5 mm
ra	1.5 mm
Cy	6.5 mm