

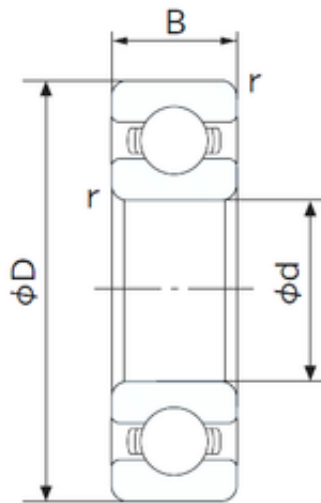

## Shandong Zhongyue Precision Bearing C...



70 mm x 90 mm x 10 mm NACHI 6814 deep groove ball bearings

Bearing No. 6814

6814 Bearing 2D drawings and 3D CAD models

Size	70x90x10 mm
Bore Diameter	70 mm
Outer Diameter	90 mm
Width	10 mm
d	70 mm
D	90 mm
B	10 mm
C	10 mm
r min.	0.6 mm
da min.	74 mm
Da max.	86 mm
ra max.	0.6 mm
Weight	0.135 Kg
Basic dynamic load rating (C)	12,1 kN
Basic static load rating (C0)	11,9 kN
(Grease) Lubrication Speed	7000 r/min
Category	Single Row Ball Bearings
Inventory	0.0
Manufacturer Name	NACHI
Minimum Buy Quantity	N/A
Weight / Kilogram	0.136
EAN	4991893805765
Product Group	B00308
Enclosure	Open
Precision Class	ABEC 1   ISO P0



## Shandong Zhongyue Precision Bearing C...

Maximum Capacity / Filling Slot	No
Rolling Element	Ball Bearing
Snap Ring	No
Internal Special Features	No
Internal Clearance	C0-Medium
Inch - Metric	Metric
Long Description	70MM Bore; 90MM Outside Diameter; 10MM Outer Race Diameter; Open; Ball Bearing; ABEC 1   ISO P0; No Filling Slot; No Snap Ring; No Internal Special Features
Category	Single Row Ball Bearing
UNSPSC	31171504
Harmonized Tariff Code	8482.10.50.68
Noun	Bearing
Keyword String	Ball
Manufacturer URL	<a href="http://www.nachi.com">http://www.nachi.com</a>
Manufacturer Item Number	6814 BNLS
Weight / LBS	0.3
Outside Diameter	3.543 Inch   90 Millimeter
Outer Race Width	0.394 Inch   10 Millimeter
Bore	2.756 Inch   70 Millimeter
Bore Type	Cylindrical Bore
Configuration	Single Row
Bore Size	70 mm
Width	10 mm
Fillet Radius/Chamfer	0.6 mm
Dynamic Load Rating	12,100 N
Static Load Rating	11,900 N
Limiting Speed - Grease	7,000 rpm
Limiting Speed - Oil	8,100 rpm



## Shandong Zhongyue Precision Bearing C...

Factor $f_0$	16.1
Radial Clearance	0.010 to 0.030 mm
$d_a$ (min)	74 mm
$D_a$ (max)	86 mm
$r_a$ (max)	0.6 mm